



DENE B



Precision Live Center



FEATURES

- *C series Live center is designed for use in CNC lathes. Due to the different sizes of live Center, it is suitable for turning various workpieces..
- The center of the live center is hardened and precisely ground. Live center have 0.005 backlash.
- The lively center end is designed to be long.it deal at the axial and radial loads evenly throughout the tailstock body. Extends bearing and live center life.
- Thanks to the lubrication cover on the back of the rotating tailstock, the tailstock can maintain its precision for many years.
- The body of the live center and the center are made of wear-resistant heat treatment steel and hardened.
- Thanks to the triple designed bearing system, it provides a rigid and cleaner turning surface.
- Thanks to its precision and quality bearings, it is resistant to axial and radial loads as well as high speeds.
- The bearings are protected against liquid and environmental contamination by means of a seal mounted on the front cover of the rotating tailstock.



Precision Live Center

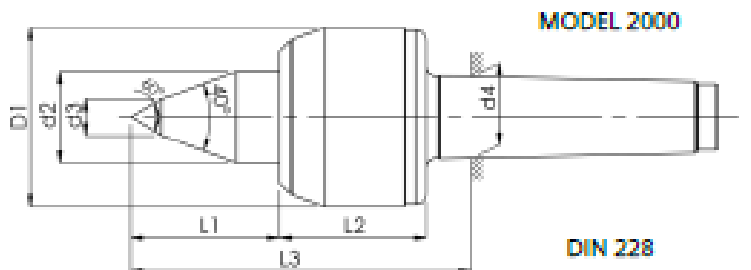
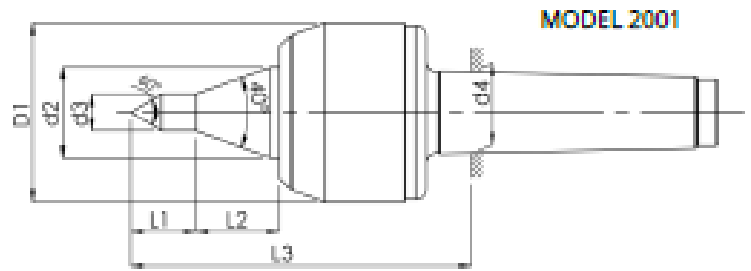

| MODEL | | 2000 | | | 2001 | | |
|-----------------|-----|--------|--------|--------|--------|--------|--------|
| | MK | 3 | 4 | 5 | 3 | 4 | 5 |
| Dimensions mm | D1 | 58 | 68 | 78 | 58 | 68 | 78 |
| | d2 | 24.5 | 34.5 | 43.5 | 24.5 | 34.5 | 43.5 |
| | d3 | 9 | 14 | 14 | 9 | 14 | 14 |
| | d4 | 23,235 | 31,267 | 44,399 | 23,235 | 31,267 | 44,399 |
| | L1 | 43 | 57 | 68 | 15 | 25 | 25 |
| | L2 | 51 | 56 | 69 | 28 | 32 | 44 |
| | L3 | 102 | 123 | 148 | 107 | 121 | 148 |
| Center Runout / | Ma | 0.005 | 0.005 | 0.005 | 0.005 | 0.005 | 0.005 |
| Weight | x | 1,5 | 2,5 | 4,5 | 1,5 | 2,5 | 4 |
| Order Code | kg. | C30 | C40 | C50 | C60 | C70 | C80 |